

Request to plant trees in Ellerslie Play Area

The Parish Council has been approached by an outdoor educator at Sticklepath Primary School where they have developed, with the children, a diverse, wildlife friendly habitat in their grounds. They are now looking to areas beyond the school and have asked if they could plant a small copse of trees from the Devon Wildlife Trust in the Ellerslie Play Area.

Our Maintenance and Amenities Operative has met the educator on site to discuss the proposal and attached is a map showing the species and proposed locations. I have discussed the proposals with the Maintenance and Amenities Operative and neither of us would support the proposal for Blackthorn in or around the play area or planting in front of the houses where the Blackthorn is shown on the map – this is currently an open area with just a fence and planting in this area will impact on the amenity of the properties.

The Ellerslie Play Area is leased from the North Devon Council and I have asked the Estates Department if the Parish Council would require permission from NDC as the landowner, I am awaiting confirmation.

Once planted the Parish Council would have to accept liability for the ongoing maintenance and inspection of the trees in the future.

V Woodhouse  
January 2021

ITEM 6a

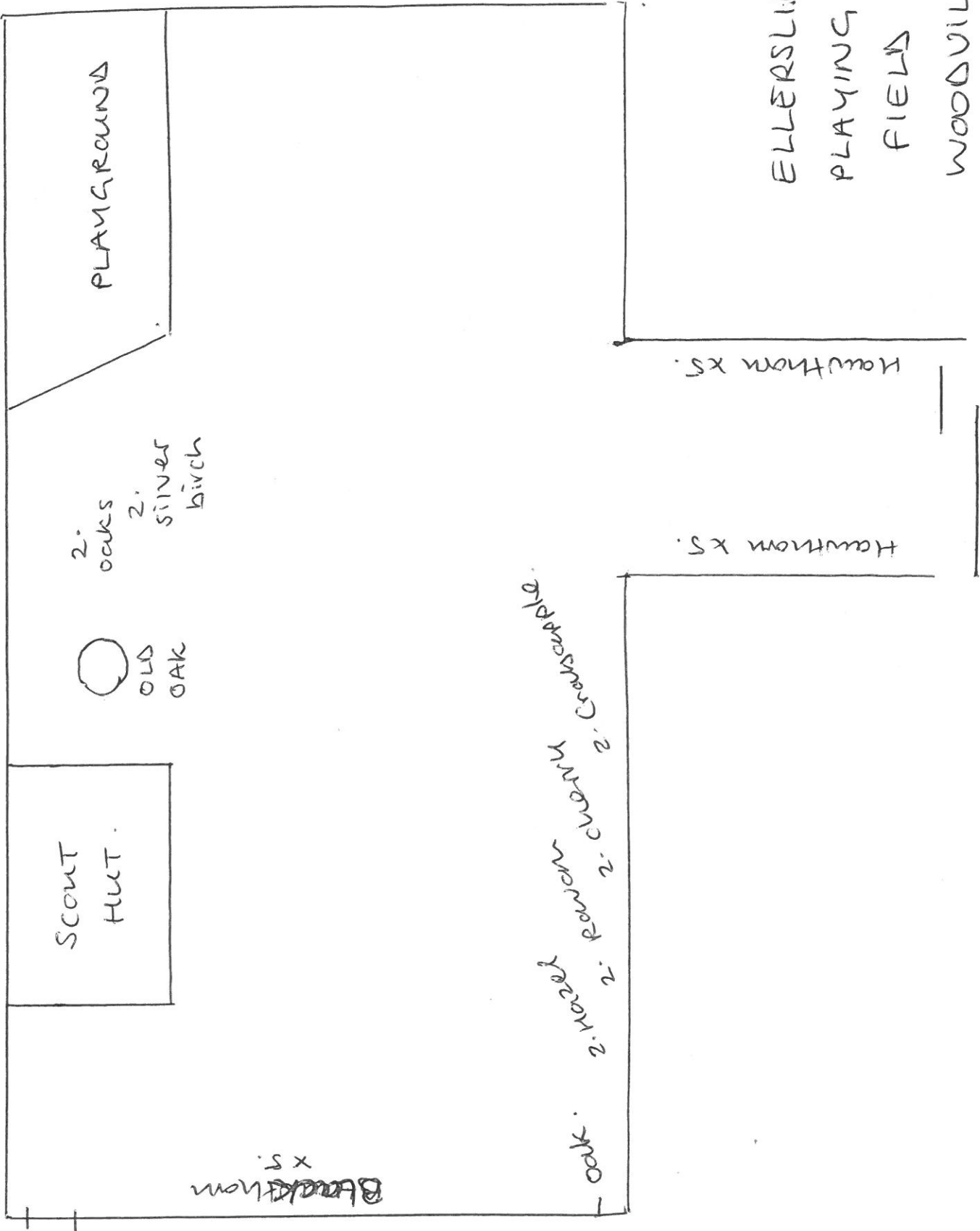

NOT TO SCALE.